

2023 Burleigh County Real Estate Tax Statement

Check here to request receipt
(No receipt will be sent unless requested)



0115-004-500

Parcel Number: 0115-004-500
Statement Number: 7644

Total tax due	5,567.06
Less 5% discount	278.35
Amount due by February 15, 2024	5,288.71
Or pay in two installments (with no discount):	
Payment 1: Pay by March 1, 2024	2,783.53
Payment 2: Pay by October 15, 2024	2,783.53

CONLIN GUNVILLE PARTNERSHIP
739 S 20TH ST WEST
BILLINGS MT 59102-6463

MAKE CHECK PAYABLE TO:

Burleigh County Treasurer
PO Box 5518
Bismarck, ND 58506-5518

MP #

Detach and return with payment

2023 Burleigh County Real Estate Tax Statement

Statement No: 7644

Parcel Number
0115-004-500

Jurisdiction
010101

Owner
CONLIN GUNVILLE PARTNERSHIP

Physical Location
1202 E FRONT AVE
BISMARCK, ND

Legal Description
Addition Name: CITY LANDS 138-80
BLK:4
CITY LANDS 138-80 Block: 4 TRACT B OF WILLIAMS SURVEY IN
SECTION 4 & 3

2023 TAX BREAKDOWN	
Net consolidated tax	5,567.06
Plus: Special Assessments	0.00
Total tax due	5,567.06
Less: 5% discount, if paid by February 15, 2024	278.35
Amount due by February 15, 2024	5,288.71
Or pay in two installments (with no discount):	
Payment 1: Pay by March 1, 2024	2,783.53
Payment 2: Pay by October 15, 2024	2,783.53

	2021	2022	2023
Legislative tax relief (3-year comparison)			
Legislative tax relief	2,727.58	2,853.91	2,976.10
Tax distribution (3-year comparison):			
True and Full Value	394,300	414,000	428,400
Taxable Value	19,715	20,700	21,420
Less: Homestead credit	0	0	0
Disabled Veterans credit	0	0	0
Net Taxable Value	19,715	20,700	21,420
Total mill levy	254.140	254.150	259.900
Taxes By District (in dollars):			
City	1,532.84	1,612.13	1,668.82
County	678.19	709.16	881.86
Park	666.36	700.08	698.94
School (after State Reduction)	2,113.26	2,218.84	2,296.02
State	19.72	20.70	21.42
Consolidated tax	5,010.37	5,260.91	5,567.06
Net effective tax rate	1.27%	1.27%	1.30%

See Important Information On Back
Please keep this portion for your records.
No receipt will be sent unless requested.

FOR ASSISTANCE CONTACT:

Office: Burleigh County Treasurer
221 N 5th Street
Bismarck, ND 58501

Phone: 701.222.6694

Website: www.burleigh.gov

WILLIAMS SURVEY

OF THE

E. 1/2 OF THE N.E. 1/4 S. 4, T. 138, R. 80.

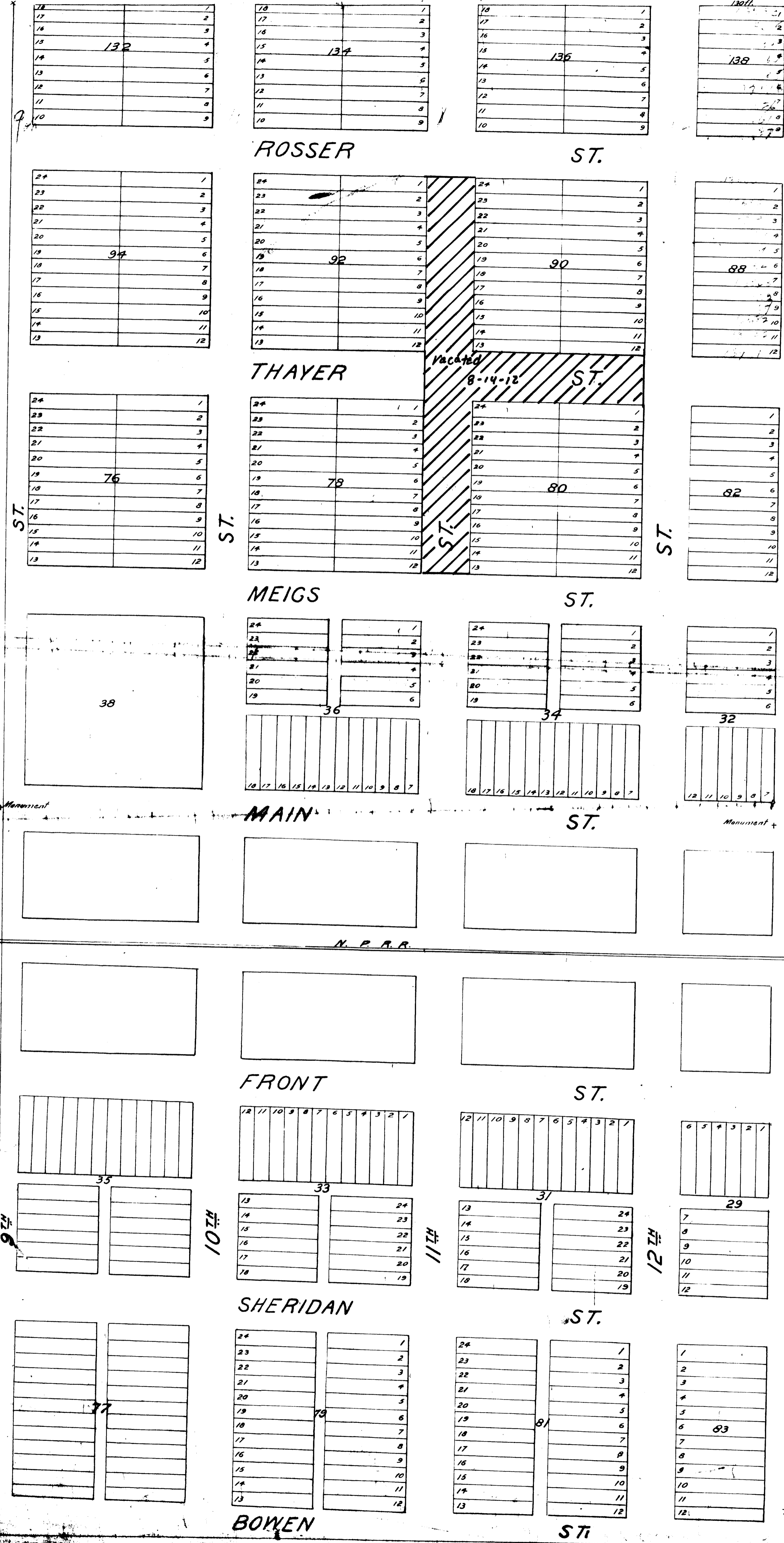

Know all men by these presents that I, Erastus A. Williams, the undersigned owner and proprietor of the following described real estate, situate in the County of Burleigh and Territory of Dakota and described as follows, to wit: The East half of the North East fourth of section four Township one hundred and thirty eight Range eighty, have caused the same to be surveyed into lots, blocks, streets and Alleys and have laid out and plotted the same as Williams Survey of the East 1/2 of the N.E. 1/4 of S. 4 T. 138 R. 80 W. as shown by the plat to which this is attached. The streets, Alleys blocks and lots of said survey are in all ways as set forth and described in the certificate of William Thompson surveyor hereunto attached.

In testimony whereof I have hereunto subscribed my name this 1st day of August 1877.

Erastus A. Williams
Proprietor

Territory of Dakota }
County of Burleigh } ss Be it remembered that on this first day of August A.D. 1877 personally appeared before me Erastus A. Williams to me well known to be the person who executed the annexed Plat and the certificate hereon and acknowledged the same to have been executed by him to the end that the same might be recorded as provided by law

J. H. Richards
Register of Deeds seal

I certify that the foregoing is a Plat of a survey of Williams Survey of the east half of the North East quarter of section 4 Township 138 Range 80 W. into Streets, Alleys, Blocks and lots named and numbered as therein designated. Its Streets are 60 feet broad excepting 9th and Bowen, and those running east and west are extensions of the streets in the City of Bismarck, D.T. Alleys are 20 feet broad Whole Blocks are 300 feet square, fractional ones are of the sizes indicated thereon. Lots in whole Blocks without Alleys are 25 by 150 feet, all others are as indicated. Block 30 is not divided. Streets running North and south are N. 30' E. as compared with the Section lines, and are at right angles with those running east and west.

This survey is separated from Bismarck by a line running through 9th Street in the center of which where it crosses the center of Main Street a stone Monument is marked and planted under ground. A similar monument is planted at the junction of the center of Main Street with the east line of said Plat.

Wm Thompson, Surveyor.

Office Register of Deeds }
County of Burleigh } ss I hereby certify the within and foregoing Plat was filed in this office for record on the 1st day of August and 1877 at 2 o'clock P.M. and was duly recorded in Book of Town Plat page

J. H. Richards
Register of Deeds

I hereby certify that this plat is a true and literal exemplification of the plat of survey to which it purports to relate now on file in the Register of Deeds Office, Bismarck, N. D.

John H. Richards
County Surveyor.

Sworn and subscribed to before me this day of 1912

Register of Deeds

Checked and corrected Feb. 19, 1915.
J. H. Richards
County Surveyor.