

2022 Burleigh County Real Estate Tax Statement

☐ Check here to request receipt
(No receipt will be sent unless requested)



0115-004-500

Parcel Number: 0115-004-500
Statement Number: 7609

Total tax due	5,260.91
Less 5% discount	263.05
Amount due by February 15, 2023	4,997.86
Or pay in two installments (with no discount):	
Payment 1: Pay by March 1, 2023	2,630.46
Payment 2: Pay by October 16, 2023	2,630.45

MAKE CHECK PAYABLE TO:

Burleigh County Treasurer
PO Box 5518
Bismarck, ND 58506-5518

CONLIN GUNVILLE PARTNERSHIP
739 S 20TH ST WEST
BILLINGS MT 59102-6463

MP #

Detach and return with payment

2022 Burleigh County Real Estate Tax Statement

Statement No: 7609

Parcel Number
0115-004-500

Jurisdiction
010101

Owner
CONLIN GUNVILLE PARTNERSHIP

Physical Location
1202 E FRONT AVE
BISMARCK, ND

Legal Description

Addition Name: CITY LANDS 138-80
BLK:4
CITY LANDS 138-80 Block: 4 TRACT B OF WILLIAMS SURVEY IN
SECTION 4 & 3

Legislative tax relief (3-year comparison)

	2020	2021	2022
Legislative tax relief	2,730.34	2,727.58	2,853.91

Tax distribution (3-year comparison):

	2020	2021	2022
True and Full Value	394,300	394,300	414,000
Taxable Value	19,715	19,715	20,700
Less: Homestead credit	0	0	0
Disabled Veterans credit	0	0	0

Net Taxable Value	19,715	19,715	20,700
-------------------	--------	--------	--------

Total mill levy	244.940	254.140	254.150
-----------------	---------	---------	---------

Taxes By District (in dollars):

City	1,354.41	1,532.84	1,612.13
County	677.43	678.19	709.16
Park	664.18	666.36	700.08
School (after State Reduction)	2,113.26	2,113.26	2,218.84
State	19.72	19.72	20.70

Consolidated tax	4,829.00	5,010.37	5,260.91
-------------------------	-----------------	-----------------	-----------------

Net effective tax rate	1.22%	1.27%	1.27%
-------------------------------	--------------	--------------	--------------

2022 TAX BREAKDOWN

Net consolidated tax	5,260.91
Plus: Special Assessments	0.00
Total tax due	5,260.91
Less: 5% discount, if paid by February 15, 2023	263.05
Amount due by February 15, 2023	4,997.86

Or pay in two installments (with no discount):

Payment 1: Pay by March 1, 2023	2,630.46
Payment 2: Pay by October 16, 2023	2,630.45

See Important Information On Back

Please keep this portion for your records.
No receipt will be sent unless requested.

FOR ASSISTANCE CONTACT:

Office: Burleigh County Treasurer
221 N 5th Street
Bismarck, ND 58501

Phone: 701.222.6694

Website: www.burleighco.com

WILLIAMS SURVEY

OF THE

E. 1/2 OF THE N.E. 1/4 S. 4, T. 138, R. 80.

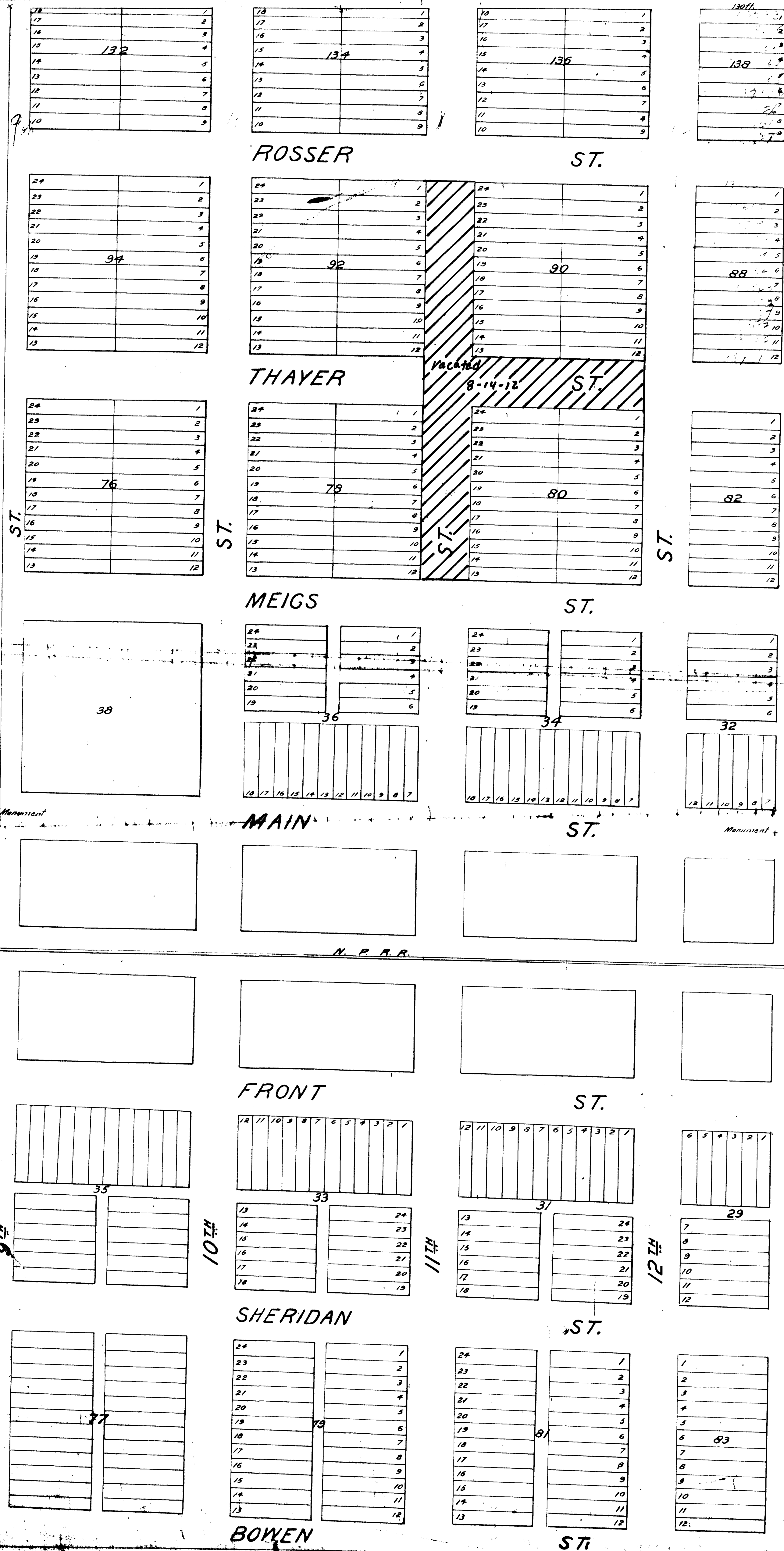

Know all men by these presents that I, Erastus A. Williams, the undersigned owner and proprietor of the following described real estate, situate in the County of Burleigh and Territory of Dakota and described as follows, to wit: The East half of the North East fourth of section four Township one hundred and thirty eight Range eighty, have caused the same to be surveyed into lots, blocks, streets and alleys and have laid out and plotted the same as Williams Survey of the East 1/2 of the N.E. 1/4 of S. 4 T. 138 R. 80 W. as shown by the plat to which this is attached. The streets, Alleys blocks and lots of said survey are in all ways as set forth and described in the certificate of William Thompson surveyor hereunto attached.

In testimony whereof I have hereunto subscribed my name this 1st day of August 1877.

Erastus A. Williams
Proprietor

Territory of Dakota }
County of Burleigh } ss. Be it remembered that on this first day of August A.D. 1877 personally appeared before me Erastus A. Williams to me well known to be the person who executed the annexed Plat and the certificate hereon and who acknowledged the same to have been executed by him to the end that the same might be recorded as provided by law

J. H. Richards
Register of Deeds seal

I certify that the foregoing is a Plat of a survey of Williams Survey of the east half of the North East quarter of section 4 Township 138 Range 80 W. into Streets, Alleys, Blocks and lots named and numbered as therein designated. Its Streets are 60 feet broad excepting 9th and Bowen, and those running east and west are extensions of the streets in the City of Bismarck, D.T. Alleys are 20 feet broad. Whole Blocks are 300 feet square, fractional ones are of the sizes indicated thereon. Lots in whole Blocks without Alleys are 25 by 150 feet, all others are as indicated. Block 30 is not divided. Streets running North and south are N. 30' E. as compared with the Section lines, and are at right angles with those running east and west. This survey is separated from Bismarck by a line running through 9th Street in the center of which where it crosses the center of Main Street a stone Monument is marked and planted under ground. A similar monument is planted at the junction of the center of Main Street with the east line of said Plat.

Wm Thompson, Surveyor.

Office Register of Deeds }
County of Burleigh } ss. I hereby certify the within and foregoing Plat was filed in this office for record on the 1st day of August and 1877 at 2 o'clock P.M. and was duly recorded in Book of Town Plat page

J. H. Richards
Register of Deeds

I hereby certify that this plat is a true and literal exemplification of the plat of survey to which it purports to relate now on file in the Register of Deeds Office, Bismarck, N. D.

John H. Richards
County Surveyor.

Sworn and subscribed to before me this day of 1912

Checked and corrected Feb. 19, 1915.

John H. Richards
County Surveyor.

Register of Deeds