



SPACE AVAILABLE:

Lot Size: 33,717.84 SF (0.774 Acres)
Building Size: 10,000 SF

PRICE:

\$2.395 Million

HIGHLIGHTS:

- Well Established Restaurant & Bar
- Located directly in Riverdale
- Income and expenses to be provided to qualified buyers.
- Located right next to lodging and the great Lake Sakakawea!
- Assemble space in the lower level to host all parties and celebrations.



Scott Ritter

**Broker Associate | Partner
Commercial Realtor®**

701.223.2450

scott@aspengroupprealestate.com

424 S 3rd Street, Suite 2 | Bismarck, ND | WWW.ASPENGROUPPREALESTATE.COM

This information has been secured from sources we believe to be reliable, but we make no representation or warranties, expressed or implied, as to the accuracy of the information. All references to age, square footage, income and expenses are approximate. Buyers or lessors should conduct their own independent investigations and rely on those results.

PROPERTY DETAILS

Parcel: 83130300011010

Legal: Lot 11 B of Lot 11 Blk 1

Zoning: Commercial

2022 Taxes: \$6,200.99

Special Assessments: None at this time

BUILDING PLAN

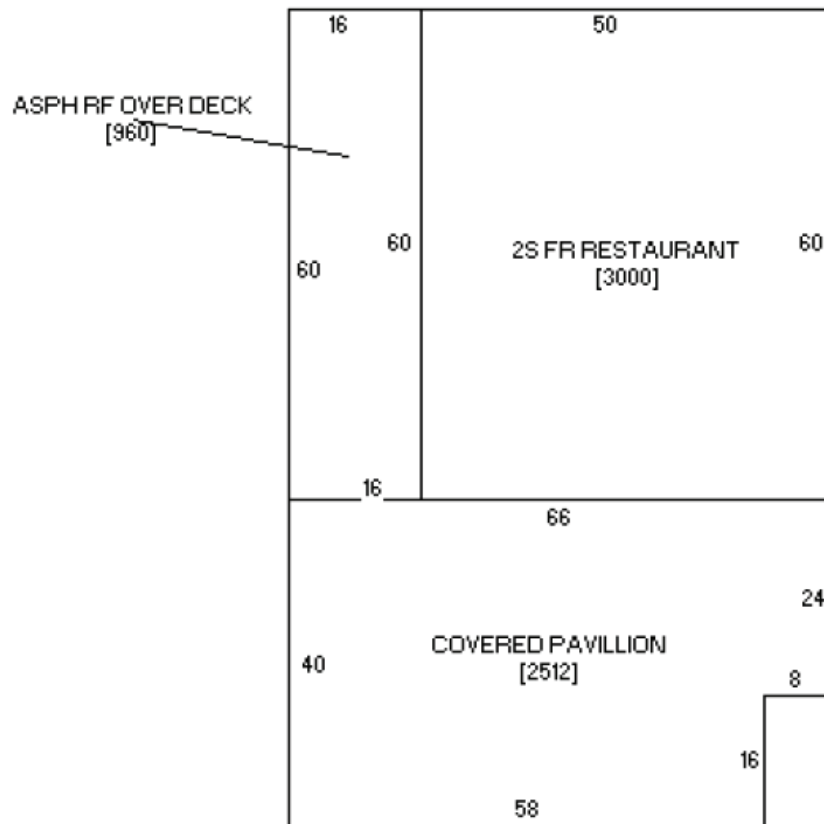

Scott Ritter

Broker Associate | Partner
Commercial Realtor®

701.223.2450

scott@aspengrouprealestate.com

INTERIOR PICTURES



Scott Ritter

Broker Associate | Partner
Commercial Realtor®

701.223.2450

scott@aspengroupprealstate.com

EXTERIOR PICTURES



Scott Ritter

Broker Associate | Partner
Commercial Realtor®

701.223.2450

scott@aspengroupprealstate.com

LOCATION MAP



Scott Ritter

Broker Associate | Partner
Commercial Realtor®

701.223.2450

scott@aspengroupprealestate.com