



**PRESENTED BY:**

**George Yineman, Commercial Realtor**  
**701.223.2450 office**

email: [george@aspengrouprealestate.com](mailto:george@aspengrouprealestate.com)  
web: [aspengrouprealestate.com](http://aspengrouprealestate.com)

# FOR LEASE

## 218 South 26th Street



**Great Location in SE Bismarck**  
**One Block South of Main Avenue**

- Price:** \$6.50 PSF
- Building Size:** 9,520 SF
- Lot Size:** 56,109 SF (1.29 A)
- Zoned:** MA Light Industrial
- Features:** Highly Visible For Retail  
Fenced Yard  
22' Sidewall Height  
Showroom with Storefront



REAL ESTATE SERVICES

701-223-2450 office  
701-223-2322 fax  
Bismarck, North Dakota

**Data Information Sheet  
SE Bismarck Land and Building**

**Building Size:** 9,520 SF

**Lot Size:** 56,109 SF (1.29 acres)

**Zoned:** MA Light Industrial

**Utilities:** \$356.00 Average Monthly

**2006 Traffic Counts:** 9,600 Cars per Day on 26th Street  
10,900 Cars per Day on Main Avenue



REAL ESTATE SERVICES  
Bismarck, North Dakota

**INFORMATION SHEET  
218 South 26th Street  
Bismarck, ND**

- 7,154 SF Warehouse/Shop
- 2,366 SF Office/Retail Area
- 1,740 SF Mezzanine Storage Area Above Office
- Class "S" Pre-engineered Metal Building
- Concrete floor with VCT tile or carpet in office and retail areas
- 1— 8 X 10 roll up overhead door on south side
- 2— 12 X 16 roll up overhead doors on west side
- 1—10 X 18 roll up overhead door on west side
- 1—10 X 12 roll up overhead door on east side
- 2— Walk-in doors in rear of building
- 1—Glass storefront entrance
- 2— Restrooms
- Floor drain in shop area
- Side wall height 22'



REAL ESTATE SERVICES  
Bismarck, North Dakota

- 2" Water Service Entrance
- 200 AMP 3 Phase Electrical Service
- 4—Reznor gas forced air space heaters
- 2—Furnaces with central air conditioning and 2 air condensers on the roof
- Insulated roof in all warehouses
- New roof installed in 2001 as a result of hail damage



REAL ESTATE SERVICES  
Bismarck, North Dakota

## Located Near

Corner of Main Avenue and 26th Street

Big Boy

Little Cottage Café

Racer Performance

Arrow Cleaning

Loaf-n-Jug

Interiors by France

River City Sports

North of Sam's Club

Walmart

Mac's Inc.

City of Bismarck Public Works

Ingersall Rand-Bobcat



REAL ESTATE SERVICES

Bismarck, North Dakota

Built: 1960  
 Addn: 1976, 1979, 1983  
 Type: 1 ST Metal  
 Whse SF: 9520  
 Total SF: 9520  
 Perimeter: 474  
 Height: 18.5' AV  
 Mezz. Office: 841  
 Mezz. Storage: 764  
 Concrete: 3643

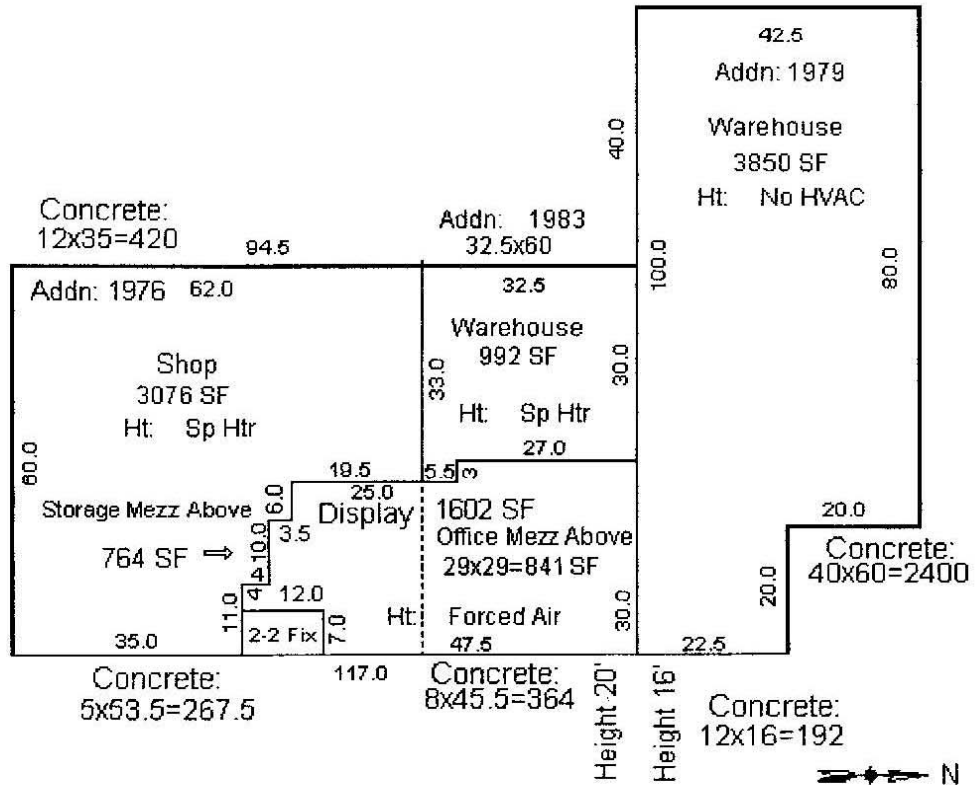

REAL ESTATE SERVICES  
 Bismarck, North Dakota



REAL ESTATE SERVICES  
Bismarck, North Dakota



REAL ESTATE SERVICES  
Bismarck, North Dakota



REAL ESTATE SERVICES  
Bismarck, North Dakota



REAL ESTATE SERVICES  
Bismarck, North Dakota



REAL ESTATE SERVICES  
Bismarck, North Dakota



Main Street-Highway 10

Little Cottage Cafe

Big Boy

Railroad Avenue

Arrow Cleaning

Racer Performance

26th Street South

Subject Property

©2008 Tele Atlas

©2007 Google™

Pointer 46°48'13.47"N 100°45'11.25"W elev. 1668 ft

Streaming 100%

Eve all 2884 f